



Ersatzteilliste

CEN Genesis GST-E Maßstab 1:8

Bestell-Nr. 610518



Wichtige Hinweise:

Dieses Produkt ist kein Spielzeug, es ist nicht für Kinder unter 14 Jahren geeignet. Das Modell ist nur für den Betrieb außerhalb geschlossener Räume vorgesehen. Beachten Sie alle Hinweise dieser Bedienungsanleitung. Diese enthält wichtige Informationen über den Umgang mit dem Fahrzeug.

Bei Schäden, die durch Nichtbeachtung dieser Bedienungsanleitung verursacht werden, erlischt die Gewährleistung/Garantie. Für Folgeschäden übernehmen wir keine Haftung! Bei Sach- oder Personenschäden, die durch unsachgemäße Handhabung oder Nichtbeachten der Sicherheitshinweise verursacht werden, übernehmen wir keine Haftung! Von der Gewährleistung und Garantie ausgeschlossen ist ferner normaler Verschleiß beim Betrieb und Unfallschäden.

Ersatzteilreferenzliste CEN GST-E

In den englischen Originalunterlagen sind Teilenummern angegeben. Um Ihnen das Bestellen der benötigten Ersatzteile zu erleichtern, finden Sie im Anschluss eine Referenzliste um die Originalnummern in Krick Bestellnummern umzuschlüsseln. Mit der Verwendung der Krick Bestell-Nummer ist sichergestellt die richtigen Teile zu erhalten. Ersatzteile erhalten Sie im Fachhandel oder unserem Onlineshop **www.krickshop.de**.

Item number	Krick Bestell-Nr.	Artikelbezeichnung	Item number	Krick Bestell-Nr.	Artikelbezeichnung
CT032	613532	Kugelpfanne 6,8mm (4)	G73915	667790	Kugellager 10x19x7 mm
FF072	611720	Servohörner verstärkt JR/Fut. (Set)	G73917	667760	Kugellager 6x10x3 mm
G36101	616101	Senkkopf-Schraube M3x10 mm (12)	G82010	67041	CEN Car BL Regler 80 A 1:8
G36112	616112	Senkkopf-Schraube M4x12mm (6)	G83131	42410	Brushless Motor 4074 KV2000 1:8
G36113	616113	Senkkopf-Schraube M4x16mm (6)	GS012	613712	Führungen mit Flansch (10)
G36153	616153	Flachkopf-Schraube M3x10 mm (6)	GS014	613714	Lenkungsteile Kunststoff
G36202	616202	Kugelkopf B5,8xM3x14 (6)	GS015	613715	Stoßdämpferwellen (4)
G36213	616213	Innensechskantschraube M4x15mm (6)	GS016	613716	Kugeln 7,8/3 mit Bund (10)
G36222	616222	Innensechskantschraube M3x12mm (6)	GS017	613717	Kugeln 6,8/3 mit Bund (10)
G36223	616223	Innensechskantschraube M3x16mm (6)	GS020	613720	Führungen mit Flansch 4x6 (10)
G36224	616224	Innensechskantschraube M3x20mm (6)	GS023	613723	Aluminium Halter (3)
G36225	616225	Innensechskantschraube M3x25mm (6)	GS025	613725	Querlenkerstift 4x56 (4)
G36228	616228	Innensechskantschraube M3x18mm (6)	GS026	613726	Querlenkerstift 4x73 (4)
G36271	616271	Madenschraube M5x5 (6)	GS027	613727	Querlenkerstift 3x44 (4)
G36301	616301	Flachkopfschraube M4x12 (6)	GS029	613729	Differentialausgang (2)
G36311	616311	Flachkopfschraube M3x10 (6)	GS035	613735	V-Profil Reifen mit Einlagen (2)
G36312	616312	Flachkopfschraube M3x52 (4)	GS044	613744	Stoßdämpferhalter
G36313	616313	Flachkopfschraube M3x16 (6)	GS045	613745	Karosseriestützen (Satz)
G36321	616321	Flachkopfschraube M5x6 (6)	GS059B	613893	Getriebeschutzplatte Aluminium blau
G36401	616401	Stopfmutter M3 schwarz (6)	GS060	613760	Differentialgetriebedeckel (2)
G36402	616402	Stopfmutter M4 (4)	GS067	613767	Spurstange r/l M8x36 mm (4)
G36501	616501	Kreuzschlitz-Blechschr.m.Bund 3x14 (6)	GS072	613772	Spurstange r/l M4x78 mm (2)
G36511	616511	Flachkopf-Blechschrabe 3x10 (6)	GS074	613774	Kugelpfanne B7,8 (10)
G36514	616514	Verbindungs-Blechschrabe 3x12 (6)	GS083	613783	Vorspurhalter hinten
G36521	616521	Rundkopf-Blechschrabe 4x12,7 (6)	GS092	613792	Antriebswelle 135 mm
G36542	616542	Senkkopf Blechschrabe 3x15 (6)	GS093	613793	Mitnehmer
G36721	616721	Pass-Stift 3x10 (2)	GS108	610948	Karosserie Genesis GST-E lackiert
G36722	616722	Pass-Stift 3x22 (2)	GS206	613906	Differentiallagerböcke A21mm (Satz)
G36724	616724	Pass-Stift 3x12 (2)	GS217	613917	Radmitnehmer Hex 23 mm (2)
G36791	616791	Karosseriesplinte 20 mm (6)	GS219	613919	Antriebswelle vorne
G36793	616793	Karosseriesplinte 28 mm (6)	GS220	613920	Differential Dichtung II (6)
G36801	616801	U-Scheibe 3x6x0,5 (6)	GS225	613925	Querlenker unten
G36802	616802	U-Scheibe 3x8x1 (6)	GS229	613929	Radmutter für Mitnehmer 23 Hex (2)
G36803	616803	U-Scheibe 4x10x0,8 (6)	GS230	613930	Stoßdämpferkolben 14 mm (3x2 Stück)
G36852	616852	E-Clips 2 (10)	GS231	613931	Stoßdämpfergehäuse 14 mm (2)
G70301	617301	O-Ring 4 mm (10)	GS232	613932	Stoßdämpferendstück lang (2)
G70302	617302	O-Ring P3,5mm (10)	GS233	613933	Stoßdämpfer Reservoir (2)
G70304	617304	O-Ring P12,5mm (6)	GS234	613934	Federvorspannclipse (2+2)
G70305	617305	O-Ring S3	GS235	613935	Stoßdämpfer Federteller unten (2)
G70306	617306	O-Ring P6mm (10)	GS236	613936	Stoßdämpfer Reservoirdeckel (2)
G70310	617310	O-Ring P10mm (6)	GS237	613937	Federanschlag oben (2)
G73914	667786	Kugellager 8x16x5 mm (2)	GS244	613944	Kardangelenkelle

Ersatzteilreferenzliste CEN GST-E

Item number	Krick Bestell-Nr.	Artikelbezeichnung
GS246	613946	Achsschenkel
GS247	613947	Achsschenkelträger
GS248	613948	Querlenker oben
GS251	613951	Obere Abstützung
GS252	613952	Untere Abstützung
GS255	613955	Spurstange r/l M8x90 mm
GS256	613956	Lenkstangen Mittelteil Kunststoff
GS257	613957	Stoßfänger unten schwarz
GS258	613958	Servosaver Achse
GS259	613959	Aluminium Hülse Lenkung
GS260	613960	Lenkungsfeder
GS261	613961	Justiermutter
GS277	613977	E-Pin 3x18 (2)
GS278	613978	Kreuzzapfen (2)
GS281	613981	Stoßfänger Halter
GS282	613982	Stoßfänger oben schwarz Nemesis
GS283	613983	Strebe Sechskant 33 mm (2)
GS287	613987	Chrom Felgen GST HEX 23 mm (2)

Item number	Krick Bestell-Nr.	Artikelbezeichnung
GS292	613992	Lenkgestänge M3x36 mm
GS296	613996	Kunststoffteile für Öldruckstoßd.reservoir
GS313	615013	Radachsen (2)
GS316	615016	Differentialgehäuse
GS330	615330	Differential Zahnradsatz GST-E
GS331	615331	Getriebegehäuse mitte GST-E
GS332	615332	Motorhalterung GST-E
GS333	615333	Halterung Batterie/Fernsteuerung GST-E
GS334	615334	Seitliche Chassisplatte blau GST-E
MX036	614236	Differentialgehäuse Matrix
MX037	614237	Antriebskegelrad 9Z. M1,5
MX040	614240	Tellerrad Differential 26Z M1,5
MX301	614601	Differentialausgang (2)
MX302	614602	Hauptzahnrad 66 Zähne Stahl
MX341	614641	Klettband Akkufixierung
MX345	614645	Scheibe Spezial 3x9
MX354	614654	Motorritzel 14 Zähne
SP23	613023	Kugelpfanne 5,8 offen+geschlossen (je 4)

Tuningteilreferenzliste CEN GST-E

Item number	Krick Bestell-Nr.	Artikelbezeichnung
G36102	616102	Senkkopf-Schraube 6-32x10 mm (6)
G36106	616106	Senkkopf-Schraube M3x16mm (6)
G70308	617308	O-Ring P8mm (10)
G70309	617309	O-Ring 10mm (6)
G70321	617321	Resorohr 3-Kammer für .21
GS013	613713	Sperrblock Differential d6
GS042	613742	Stoßfänger Set verchromt
GS067A	613894	Aluminium Spurstangen r/l M8x36 mm (4)
GS073A	613895	Aluminium Spurstangen r/l kpl. M8x90 (2)
GS084	613784	Overhead Stoßdämpfer Plastikteile
GS201	613901	Differentialzahnrad A d8mm (2)
GS202	613902	Tellerrad 26 Zähne d8 mm
GS203	613903	Differentialgetriebedeckel d8 mm
GS204	613904	Differentialausgang d8 mm
GS205	613905	Alu-Getriebegehäuse vorne od. hinten
GS214	613914	Dogbone Pattern Reifen (2)
GS215	613915	Dish Felgen Hex 23mm (2)
GS216	613916	Alu-Diff.-Gehäuse II
GS221	613921	Alu Diff. Distanzscheibe II (6)
GS224	613924	Heavy Duty Antriebswelle Pin4
GS227	613927	Differentialmitnehmer d8/Pin4
GS253	613953	CEN Emblem
GS284	613984	Stoßdämpferdistanzhülse oben (2)

Item number	Krick Bestell-Nr.	Artikelbezeichnung
GS288	613988	Gestänge für Overhead Stoßdämpfer
GS289	613989	Platte für Umlenkung Overhead Stoßd.
GS293	613993	Radmutter verchromt Hex 23 mm (2)
GS294	613994	Alu-Radmitnehmer HEX 23 mm (2)
GS326	615026	Heckspoilerhalterung
GSS06	613806	Radmitnehmer 23 mm Hex Alu (2)
GSS07	613807	Aluminium Differentialgetriebe Upgrade
GSS09	613809	Aluminium Öldruckstoßdämpfer kpl. (2)
GSS10	613810	Heavy Duty CVS + Diff.-Ausgang (1)
GSS20	613820	Tuning Achsschenkelträger Alu CNC (2)
GSS21	613821	Tuning Querlenker unten Alu CNC (2)
GSS24	613824	Stoßfänger front/heck Alu CNC
GSS27	613827	Aluminum Shocktower CNC
GSS28	613828	Differentiallagerböcke Alu CNC (2)
GSS29	613829	Headlights Alu CNC (2)
MX015	614215	Heckflügel
MX071	614271	Stoßdämpferendstück kurz (2)
MX073	614273	Servosaver Achse (2)
MX086	614286	Staubschutz Stoßdämpferstange (4)
MX094	614294	Strebe Heckflügelhalterung 58mm (2)
MX356	614656	Motorritzel 16 Zähne
MXS41	614441	Lenkhebel Servosaver CNC Alu

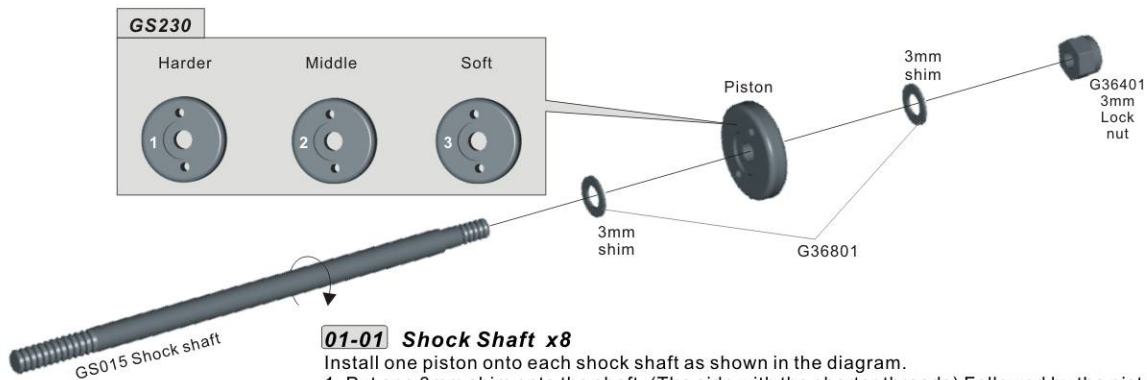
**01-01 Shock Shaft x8**

Install one piston onto each shock shaft as shown in the diagram.

1. Put one 3mm shim onto the shaft. (The side with the shorter threads) Followed by the piston then the last 3mm shim.
2. Secure the piston with one 3mm lock nut.

"Racer Tip" Thread the nut on with the nylon side first. This will help it stay in place.

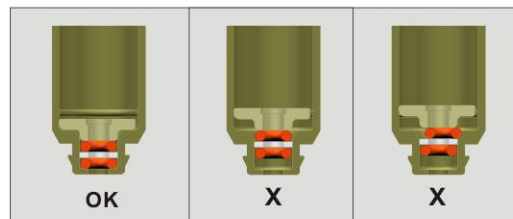
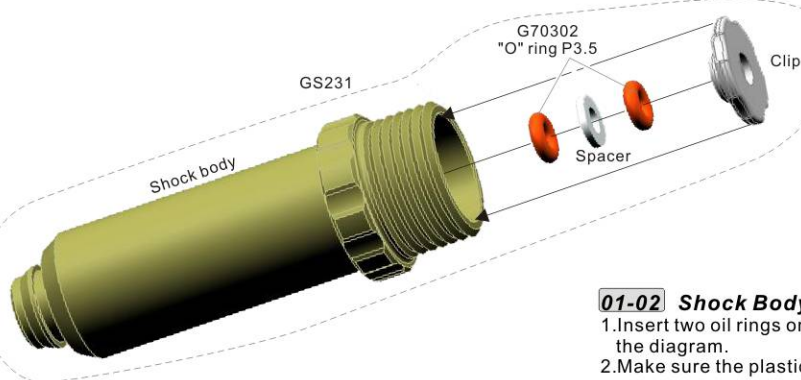
**01-02 Shock Body x8**

1. Insert two oil rings one spacer and one plastic clip into each shock body as shown in the diagram.
2. Make sure the plastic clip is fully seated in the shock body, refer to the diagram.

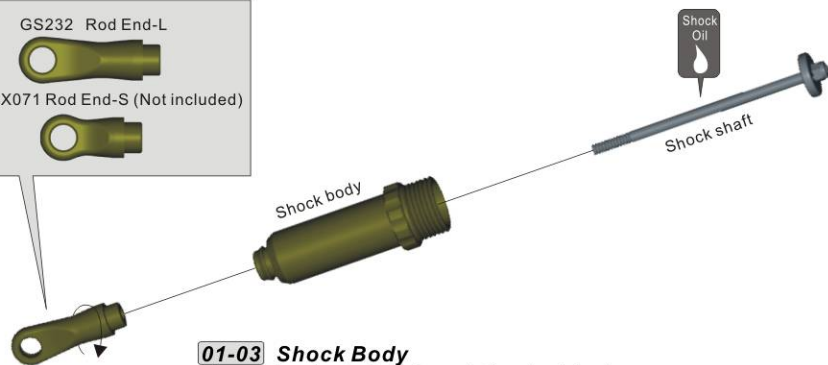
**01-03 Shock Body**

1. Insert the shock shaft through the shock body.
2. Thread the eyelet onto the shock shaft. Notice there are two sizes of Rod Ends..

"Racer Tip" Make sure you screw the Rod Ends on equally. Compare the shafts with each other and adjust Rod End if needed to make them all the same length.

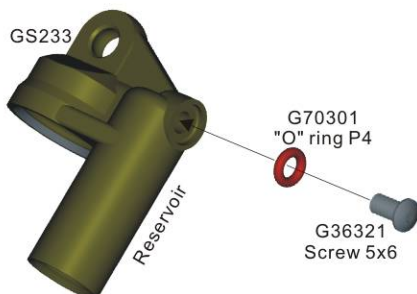
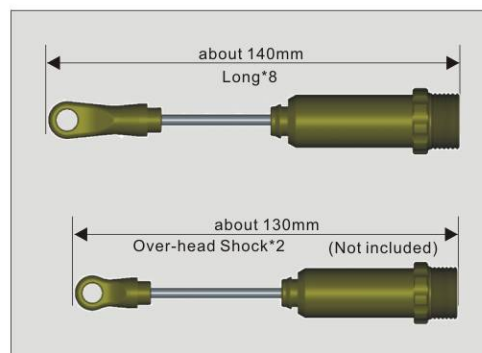
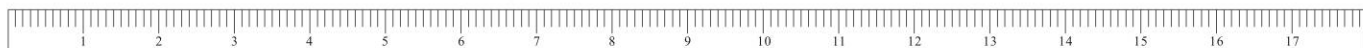
**01-04 Reservoir x8**

1. First close off the bleeder valve with one P4 "O" ring and 5x6 button head screw.
2. Repeat for each reservoir.

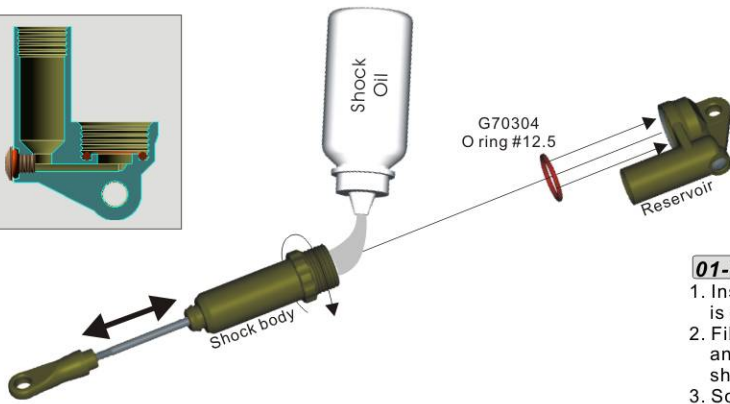
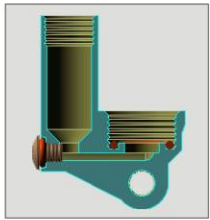

01-05 Shock Body x8

1. Insert one #12.5 "O" ring into each reservoir. Make sure the "O" ring is completely seated as shown in the diagram.
2. Fill the shock body with shock oil. Slowly move the shock shaft up and down until you get all the air bubbles out of the oil. Refill the shock to the top with oil if needed.
3. Screw the reservoir onto the shock body and tighten down.

01-06 Shock Body x8

1. Now you need to fill the reservoir with oil. Fill the reservoir up to the bottom of the threads. Now slowly move the shaft up and down to get any extra air bubbles out.
2. Refill to the bottom of the threads if needed and insert the cap with the "O" ring. Tighten down then loosen 1 full turn. Slowly push the shock shaft all the way in and while holding the shaft in tighten down the cap.
3. Check your work, the shaft should go all the way into the shock body. If it doesn't you may need to bleed the shock slightly more. Shock action should be smooth without binding.
4. Repeat for each shock.

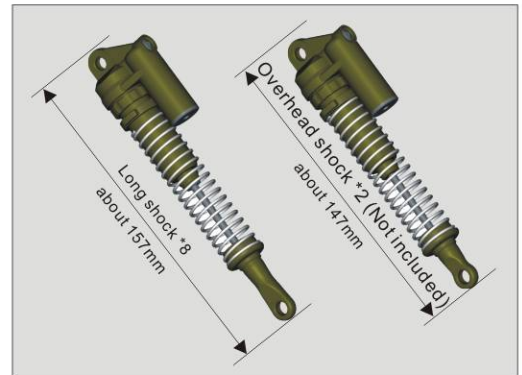
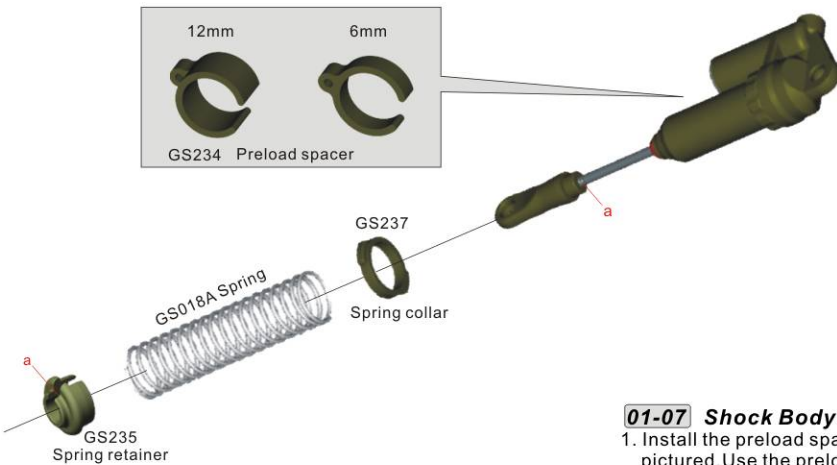
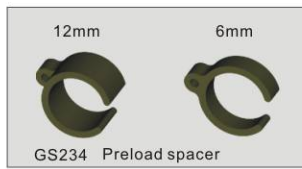
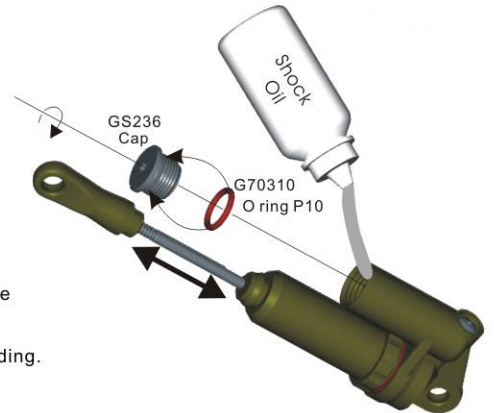

01-07 Shock Body

1. Install the preload spacers, spring collar, spring, followed by the spring retainer as pictured. Use the preload spacer to adjust the spring tension if needed.



02 Tranny Assembly

02-01 Center Diff

1. Slide one 8x16x5 bearing onto the spue gear.
2. Insert output shaft into the gear as shown. Next slide one P6 "O" ring onto the output shaft, on the inside of the gear.
3. Insert one pin through the pinhole on the output shaft followed by the gear.

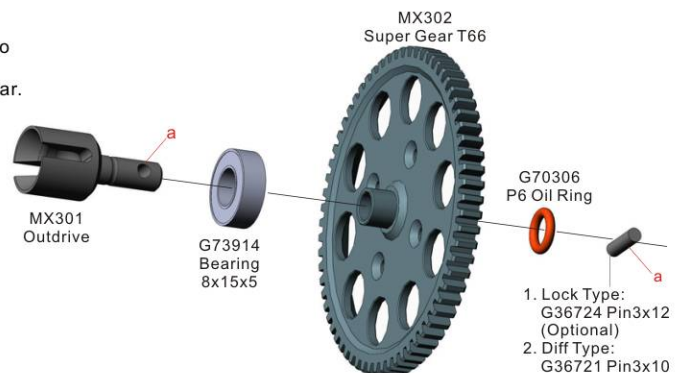

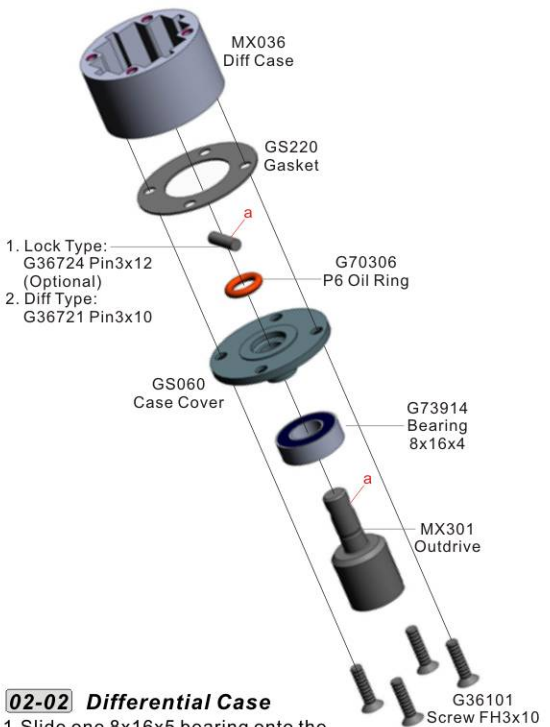

02-02 Differential Case

1. Slide one 8x16x5 bearing onto the case cover.
2. Insert outdrive into the case cover as shown. Next slide one P6 oil ring onto the outdrive, on the inside of the case cover.
3. Insert one pin through the pinhole on the outdrive followed by the oil ring.
4. Attach the case cover to the diff case using the four screws, gasket.

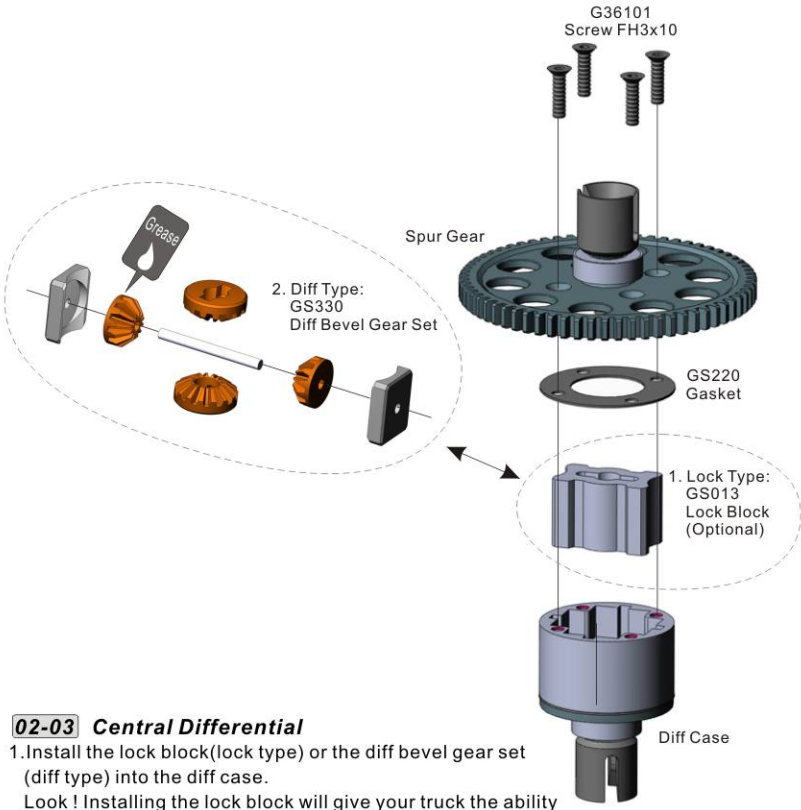

02-03 Central Differential

1. Install the lock block (lock type) or the diff bevel gear set (diff type) into the diff case. Look ! Installing the lock block will give your truck the ability pull wheelies. The use of the lock block will greatly reduce] the life of drive train parts.
2. Carefully center the gasket onto the diff case. Make sure you line up the screw holes accurately.
3. Put the two halves together as shown in the picture. Secure with four screws.

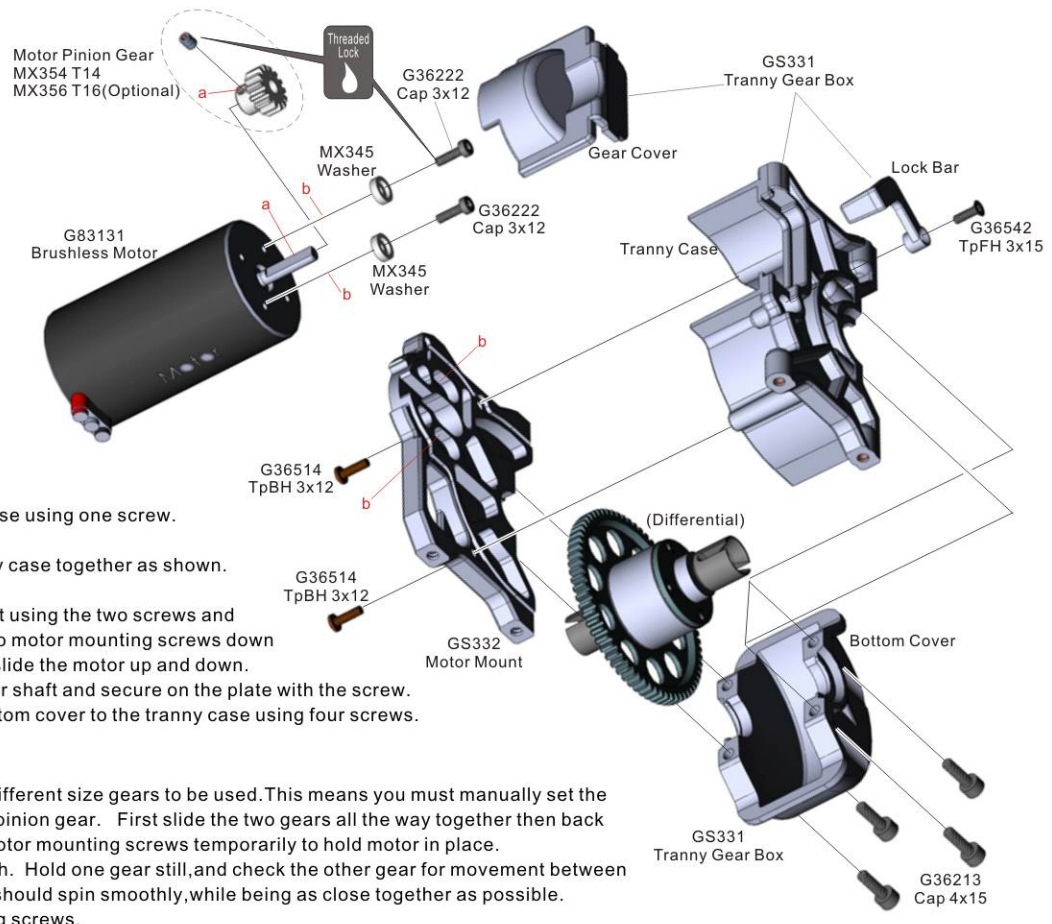

02-04 Tranny Gear Unit

1. Attach the lock bar to the tranny case using one screw. (Don't too tight to rotate.)
2. Put the motor onto the motor mount and the tranny case together as shown. Secure with two screws.
3. Put the motor onto the motor mount using the two screws and washers temporarily. Screw the two motor mounting screws down leaving them just loose enough to slide the motor up and down.
4. Slide the pinion gear onto the motor shaft and secure on the plate with the screw.
5. Secure the differential with the bottom cover to the tranny case using four screws.
6. Gear mesh will need to be set.

Setting Proper Gear Mesh

The motor mount is slotted to allow different size gears to be used. This means you must manually set the distance between the spur gear and pinion gear. First slide the two gears all the way together then back off slightly. Tighten down the two motor mounting screws temporarily to hold motor in place.

Now you need to check the gear mesh. Hold one gear still, and check the other gear for movement between them. When set correctly the gears should spin smoothly, while being as close together as possible. Tighten down the two motor mounting screws.

7. Put the gear cover onto the tranny case using the lock bar.

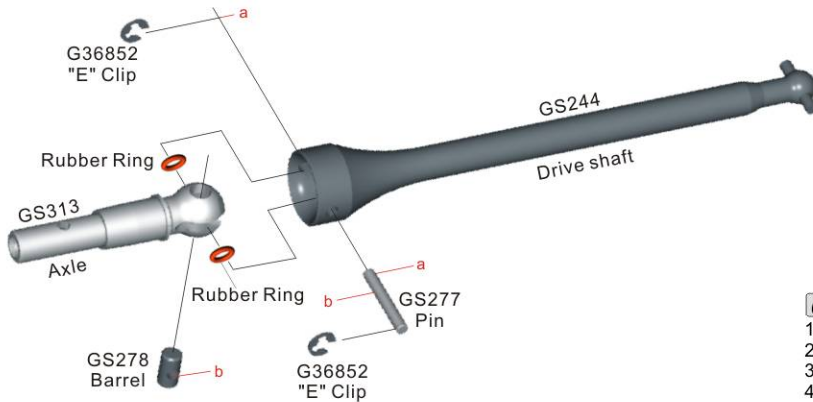
**03-01 Drive Shaft Assembly x4**

1. Insert one barrel into the axle as shown.
2. Align the pin hole on the drive shaft and barrel.
3. Push pin through and secure with two E2 "E" clips
4. Repeat three more times.

03-02 Hub and Driveshaft Assembly x4

1. Insert one 10x19x5 bearing on the inside of the spindle.
2. Insert one 8x16x5 bearing on the outside of the spindle.
3. Slide the wheel axle through the spindle and bearings as shown in the picture
4. Slide on the wheel hub and secure by inserting one 3x22 pin and setscrew.
5. Repeat for each hub.

"Racer Tip" Thread lock recommended on the setscrew.

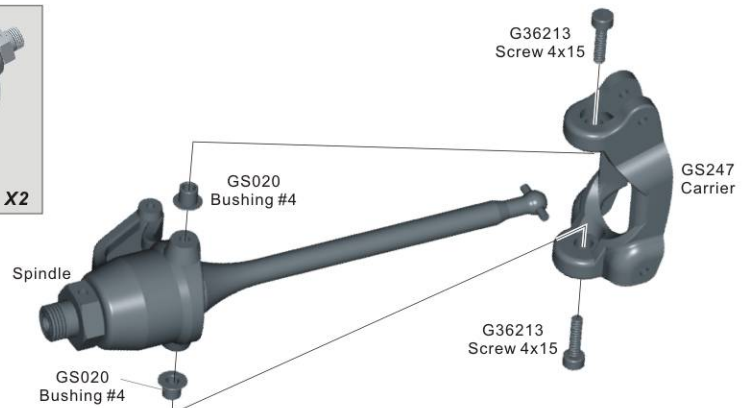
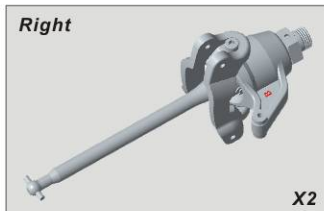
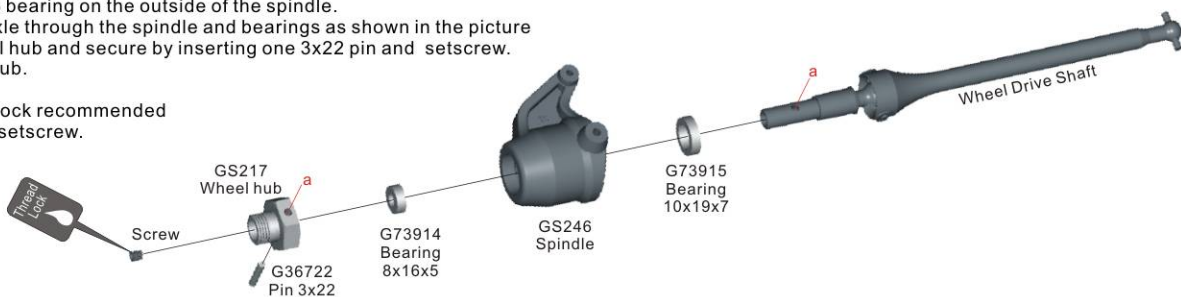
**03-03 Spindle Assembly x4**

1. Put two #4 pivot bushings into the carrier as shown in the diagram.
2. Line up the spindle pivot bushings and the spindle, and tighten down two 4x15 cap head screws.
3. Repeat for each spindle.

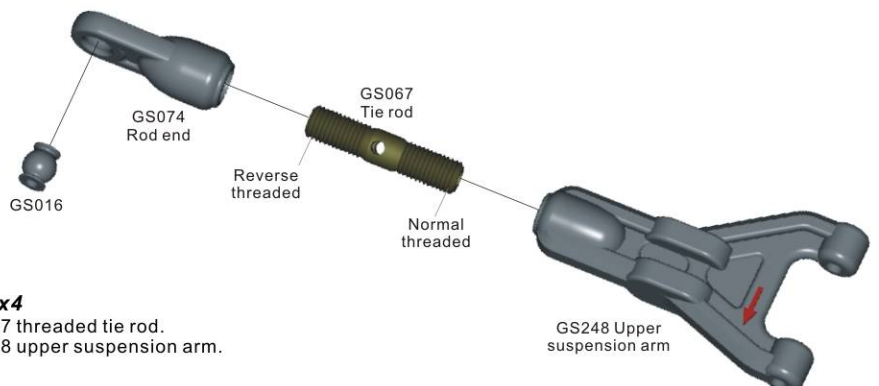
**03-04 Upper Suspension Arm Assembly x4**

1. First thread on the GS074 rod end onto the GS067 threaded tie rod.
2. Next thread the tie rod and rod end into the GS248 upper suspension arm.
3. Repeat for the other side.

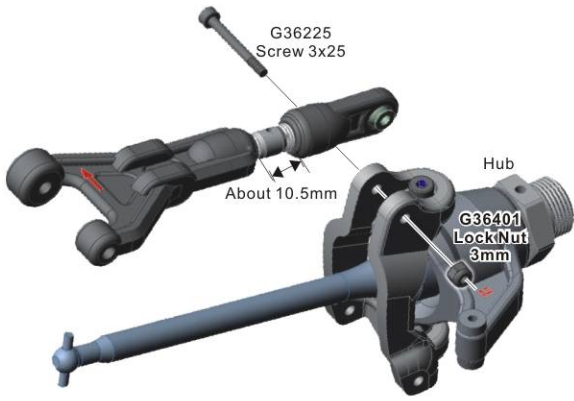

03-05 Suspension Arm Assembly (Front-right)

1. Attach the upper suspension arm to the hub using one 3x25 screw with 3mm lock nut.
2. Repeat for other side.



03-06 Suspension Arm Assembly (Front-right)

1. Attach the lower suspension arm to the hub assembly using one 3x44 screw and 3mm lock nut.

Front-left

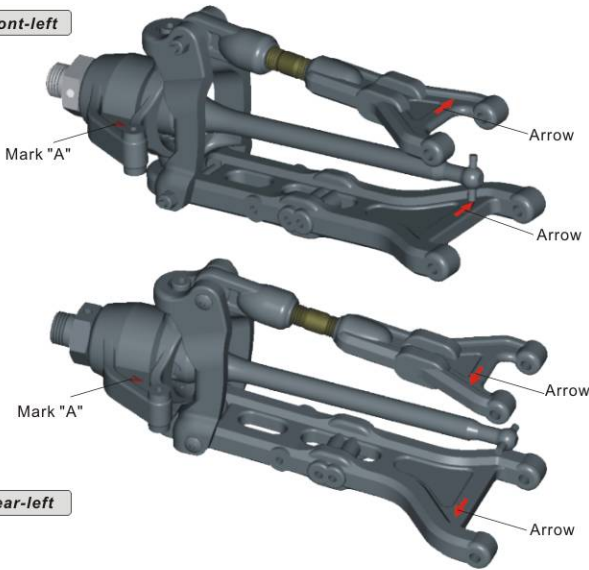

Front-right

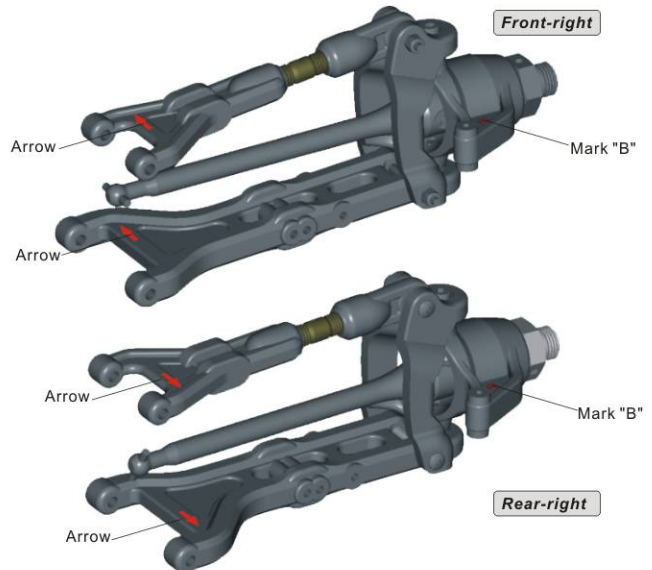

Rear-left

03-07 Suspension Arms

1. Mount the suspension arms as shown in the diagram. Notice the direction of the arms.

Notice: Look carefully and you will find an arrow. This arrow should always point towards the outside of the truck. Use this arrow for the front and rear.

04 Front and Rear Differential Assembly

04-01 Differential x2

1. Slide one G73914 bearing onto the Ring gear.
 2. Insert GS029 outdrive through the center of the Ring gear.
 3. Apply small amount of grease to the outdrive shaft followed by one P6 "O" ring.
 4. Insert one 3x10 pin finishing it up with a Bevel gear.
- Make sure you line the slot on the gear with the pin.
5. Repeat one more time.

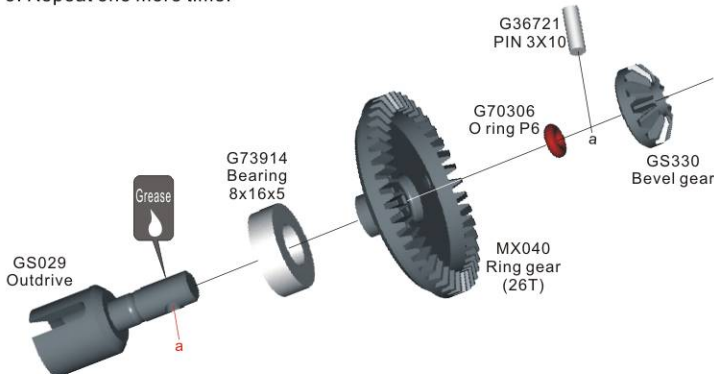

04-02 Differential x2

1. Attach the bevel gear assembly to the differential case using four 3x10 screws and gasket. Carefully tighten screws down equally to ensure a good seal.
2. Repeat one more time.

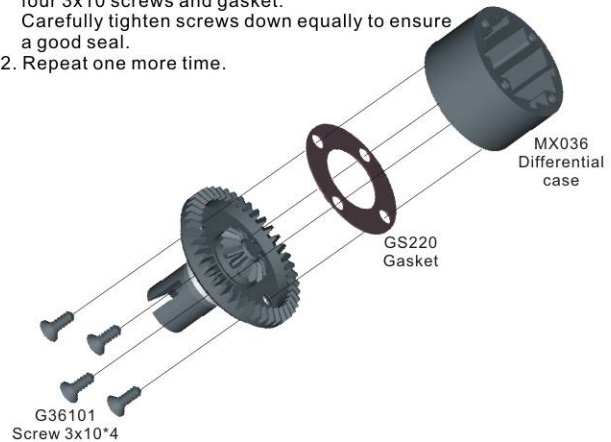

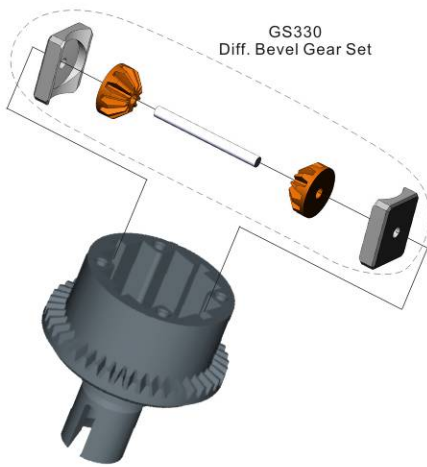

04-03 Differential x2

1. Install two small bevel gears and gear supports into the differential case. Carefully install everything making sure the bevel gears on the gears stay correctly in place.
2. Repeat one more time.



04-04 Differential x2

1. Fill the differential to the top of the smaller gears with silicon fluid.
*Don't over fill or the differential will leak.

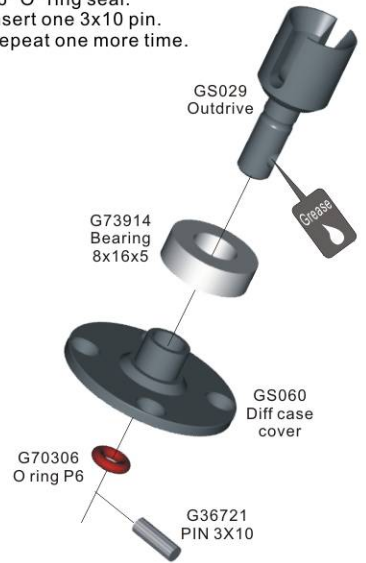

04-05 Differential x2

1. Slide one G73914 bearing onto the differential case cover.
2. Insert the GS029 outdrive through the GS060 differential case cover.
3. Apply a small amount of grease to the outdrive shaft followed by a P6 "O" ring seal.
4. Insert one 3x10 pin.
5. Repeat one more time.

04-06 Differential x2

1. Line the slot on the bevel gear up with the 3x10 pin from the outdrive cup.
2. Assemble the differential using one gasket and one differential shim, using four screws.
* Thread lock is highly recommended on these screws.

"Racer Tip" Tighten down the four screws evenly making sure they are all equally snug.

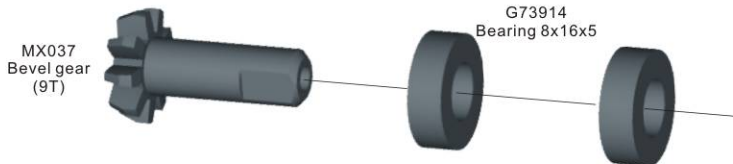

04-07 Bevel Pinion Gear x2

1. Slide two bearings onto the bevel gear.

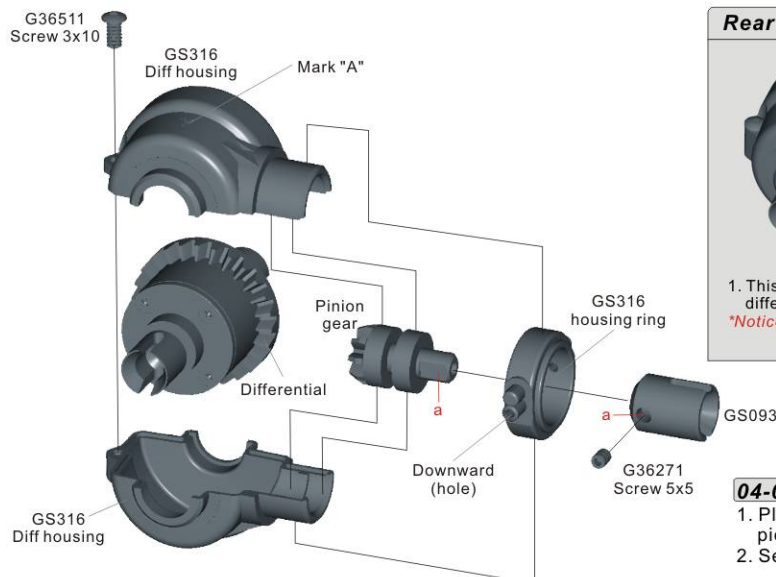

Rear Gear Box

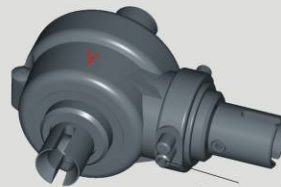

1. This is the finished assembled rear differential.
**Notice* the location of the hole on the housing ring.

Front Gear Box

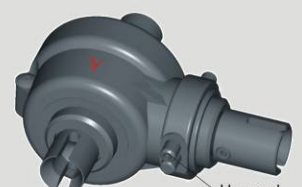

1. This is the finished assembled front differential.
**Notice* the location of the hole on the housing ring.

04-08 Rear (Front) Gear Box

1. Place the differential and pinion gears inside the differential housing as pictured in the diagram.
2. Secure with one 3x10 screw and housing ring.

05-01 Rear(front) Bulkhead

1. Assemble the two bulkheads together as shown.
2. Screw in two 3x10 screws with washers.
3. Repeat for the front.

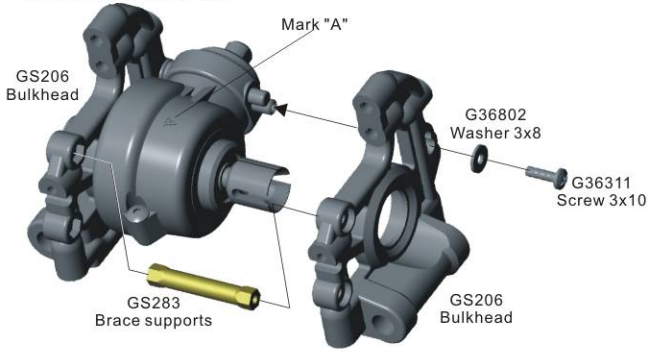
**05-02 Rear(front) Bulkhead**

1. Secure the GS044 shock tower to the bulkheads using four 4x15 cap screws.
2. Repeat for the front.

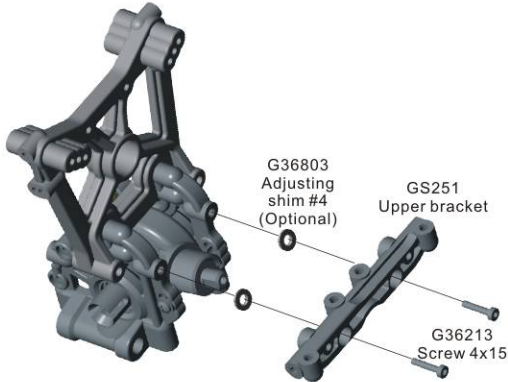
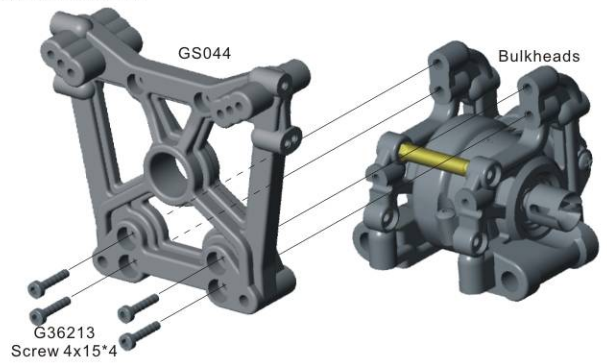
**05-03 Upper Bracket x2**

1. Secure the bracket to the rear bulkhead using two 4x15 screws.
2. Repeat for the front.

05-04 Front (Rear) End

1. Attach the suspension arms using two pin screws, two aluminum braces, followed up with lock nuts.
2. Repeat for the rear.

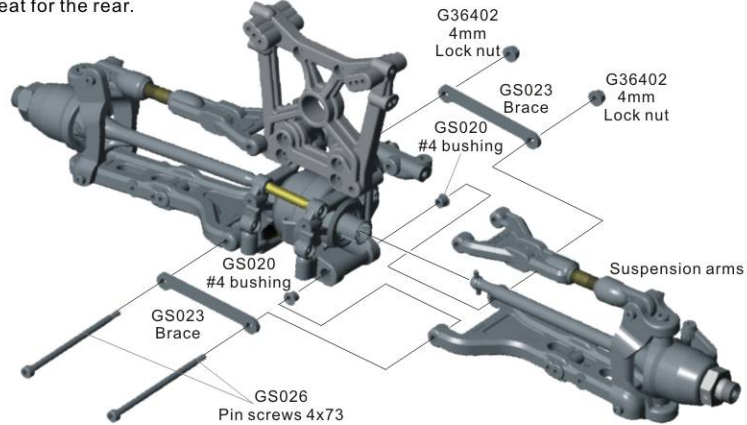
**05-05 Front (Rear) End**

1. Now install the upper suspension arms and braces using pin screws, and aluminum brace.
2. Repeat for the rear.

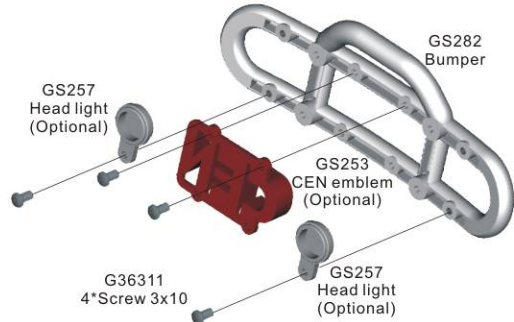
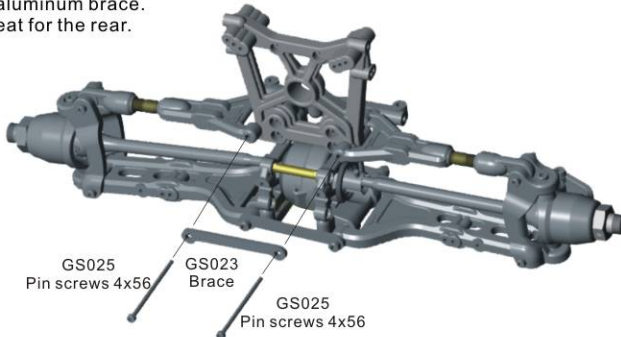
**05-06 Front Bumper**

1. Attach the CEN emblem and head lights using screws to the bumper.

05-07 Front Bumper

1. Attach bumper and bumper support using two 3x10 and two 3x16 button head screws. Notice 3x16 screws must go through bumper support into the bumper.

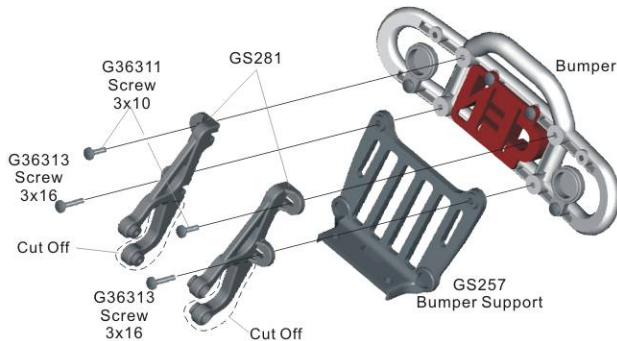
**05-08 Rear Bumper**

1. Attach the bumper and bumper support using two 3x10 and two 3x16 button head screws. Notice 3x16 screws must go through bumper support into the bumper.

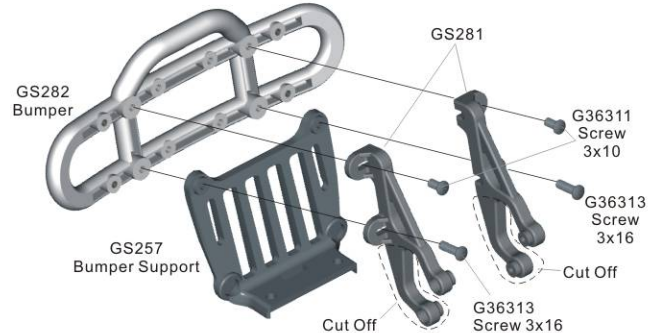

05-09 Front (Rear) Bumper

1. Attach the front (rear) bumper assemblies using two 3x16 cap head screws.

Notice: Thread lock recommended for these screws.

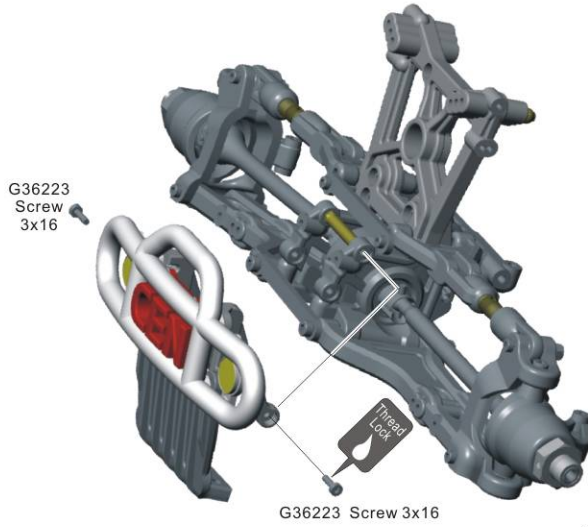

05-10 Front (Rear) Shocks

1. Press in one shock mount pivot ball into the upper and lower eyelets for each shock.
2. Attach two shocks to each suspension arm using two screws and two lock nuts.

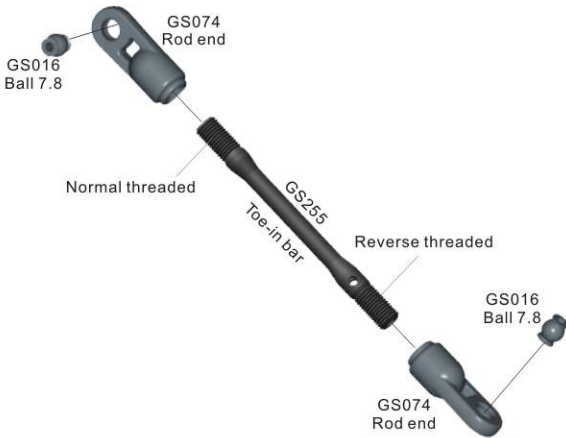
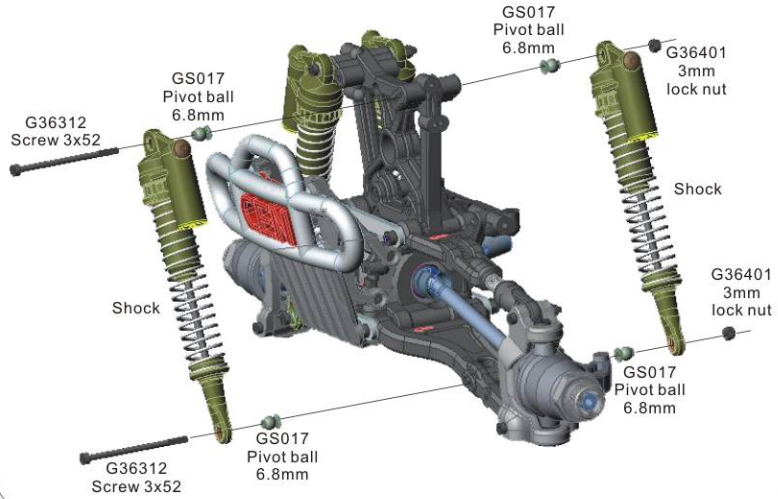

05-11 Rear Toe-in Bar x2

1. Thread the rods ends onto the rear toe-in bars.
2. Press one pivot bushing into each rod end.

Notice: Carefully look at the eyelet holes. Insert bushing into open side.

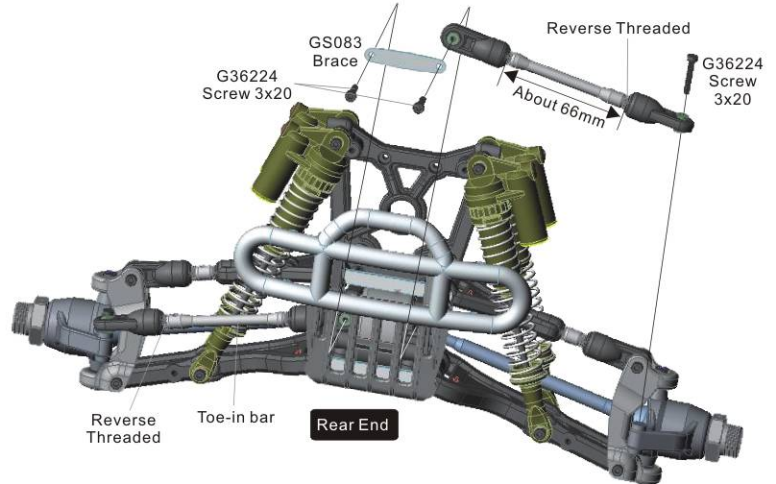

05-12 Rear Toe-in Bar

1. Secure the toe-in bars with brace to the rear bulkhead using two screws.
Notice: Mount bars with adjusting hole on the outside for easier adjustment.
2. Secure the outer side of the bar to the rear spindle using two screws.

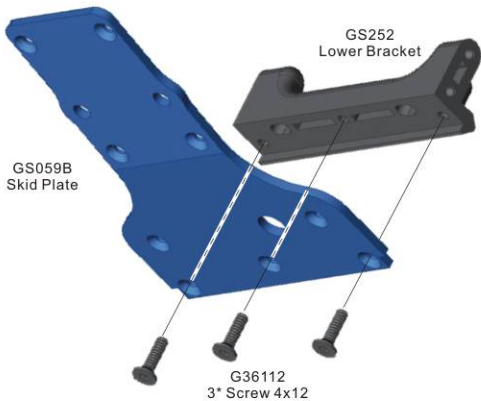

05-13 Lower Bracket x2

1. Mount one bracket onto front and rear skid plates using three screws.

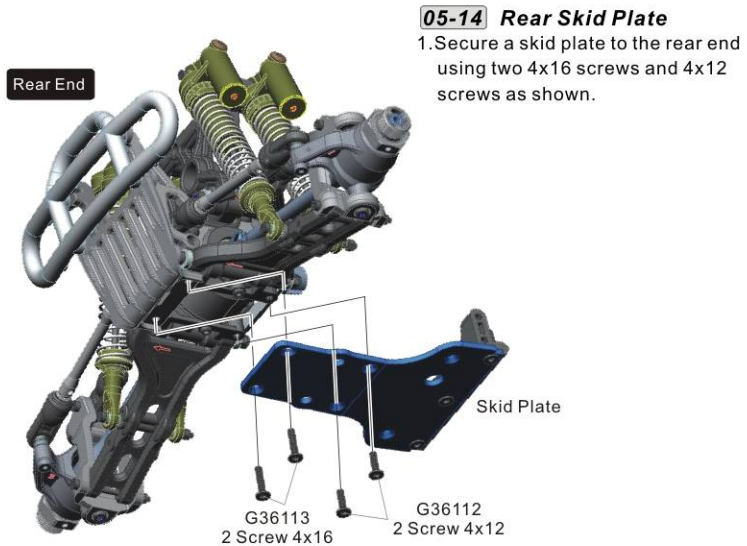

05-14 Rear Skid Plate

1. Secure a skid plate to the rear end using two 4x16 screws and 4x12 screws as shown.

05-15 Servo Saver

1. Screw ball stud into the saver
2. Assemble the servo saver as shown. Make sure the hex on the tube is correctly seated.
3. Tighten the spring tension down until you have 6mm of threads exposed.

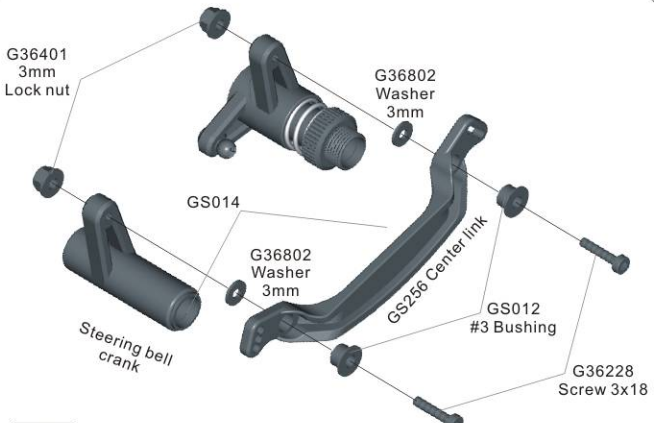
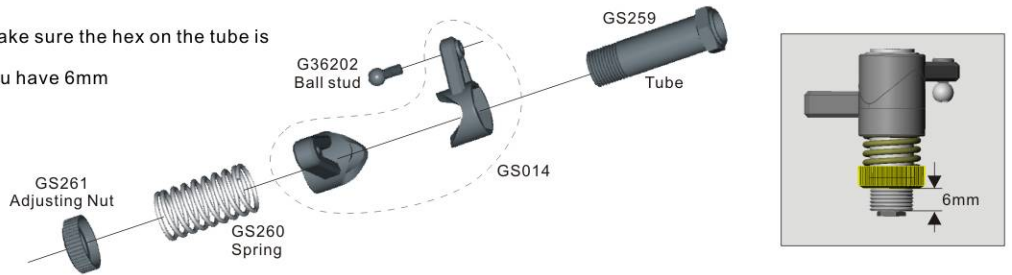

05-16 Steering Bell Crank

1. Attach the center link to each steering bell crank using screws, two 3mm washers, two lock nuts and the #3 bushings. Double check you have the parts in the correct order as pictured.
2. Bell cranks should pivot freely. Loosen screws slightly if needed.

05-17 Servo Saver

1. Attach two steering posts onto the front bottom plate using two screws. **Notice:** Thread lock is recommended for these screws.
2. Next put four bearings into the upper and lower of the bell cranks as shown in the picture.

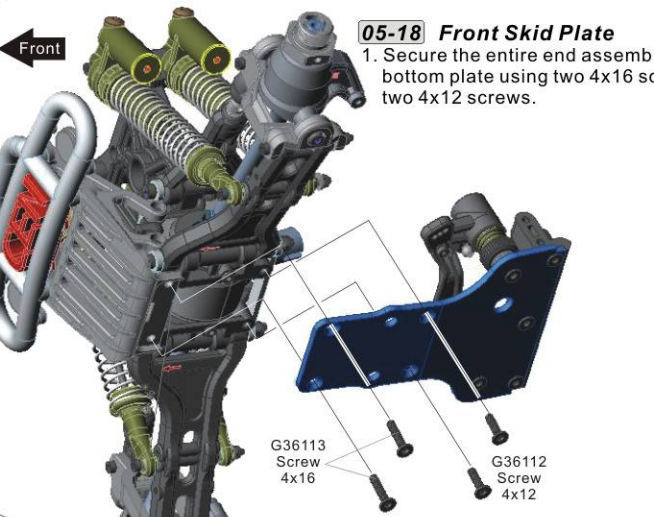
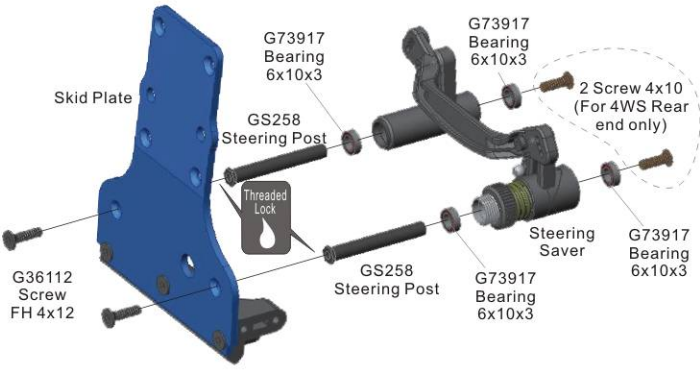

05-18 Front Skid Plate

1. Secure the entire end assembly onto the bottom plate using two 4x16 screws and two 4x12 screws.

05-19 Steering Rod Assembly x2

1. Thread two red end into two steering rods.
2. Press in one pivot bushing into each rod end. **Notice:** Carefully look at the eyelet holes. Insert bushing into open side.

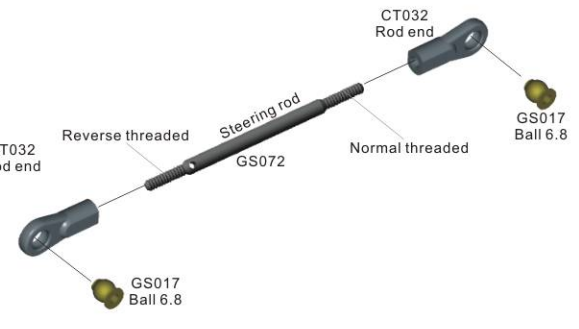

05-20 Steering Rods

1. First mount the steering rods to the bell cranks using two 3x18 screws and 3mm lock nuts. The steering rod should be mounted to the bottom side of the bell cranks.
2. Next mount the outer side of the steering rod to the spindles using two 3x20 screws.

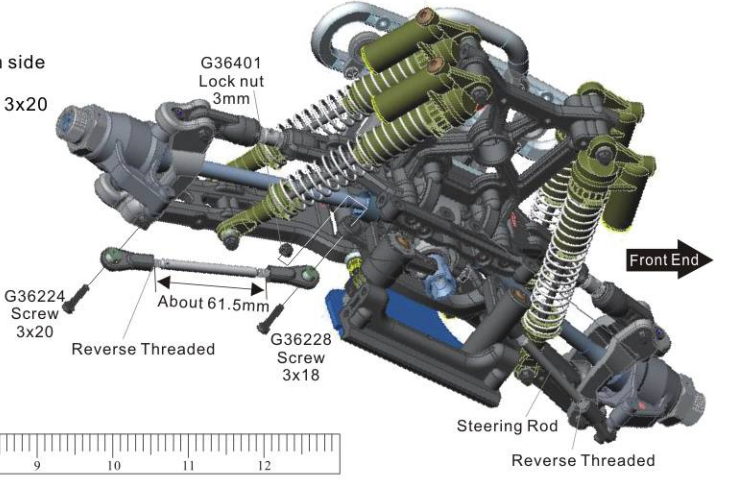

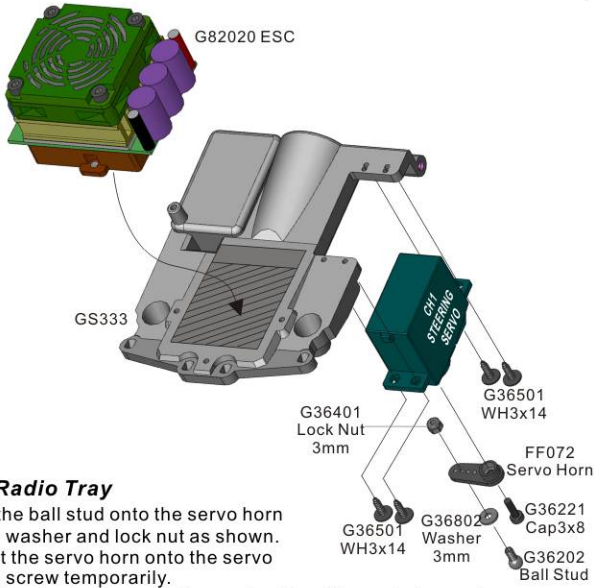
**06-01 Radio Tray**

1. Attach the ball stud onto the servo horn with the washer and lock nut as shown. Next put the servo horn onto the servo with the screw temporarily.
2. Mount the steering servo to the underside of the radio tray using four screws.
3. Put the ESC onto the radio tray with the double side tape as shown.

06-02 Radio Tray

1. Align the electric wires properly.
2. Feed the antenna wire of the receiver through the outlet hole located on the inside of the receiver compartment.
3. Put the receiver into the inside of the receiver compartment with the receiver cover and hook pin.

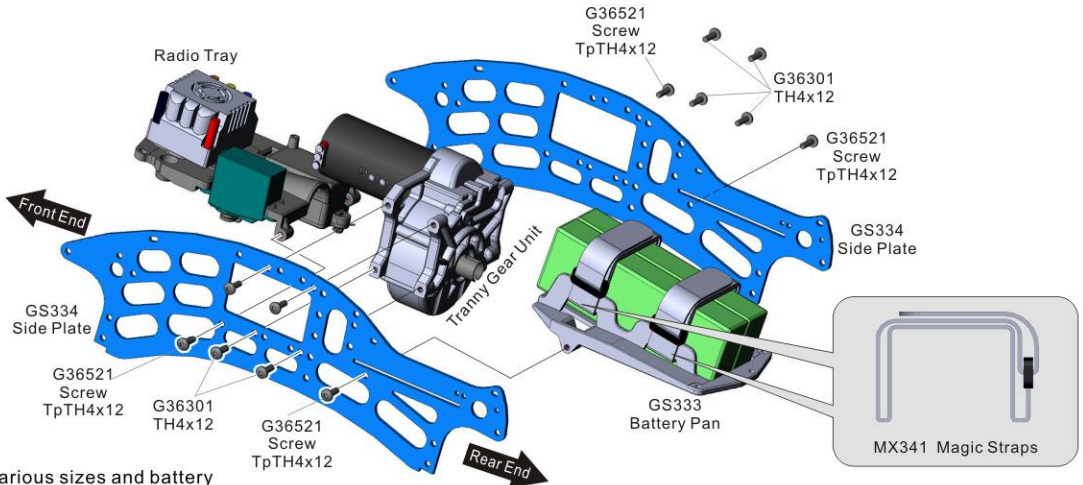
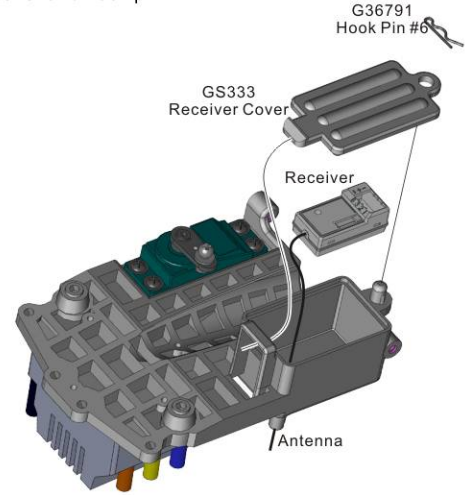
**06-03 Middle Frame**

1. The battery tray can secure various sizes and battery configurations.
2. Secure your battery by using the magic straps as shown.
3. Be sure that your battery is tight and unable to move within the battery tray, any battery movement can cause serious damage.
4. Assemble the center sections to the side plates as shown in the following order. 1st>the tranny gear unit, 2nd>the radio tray, 3rd>the battery tray.

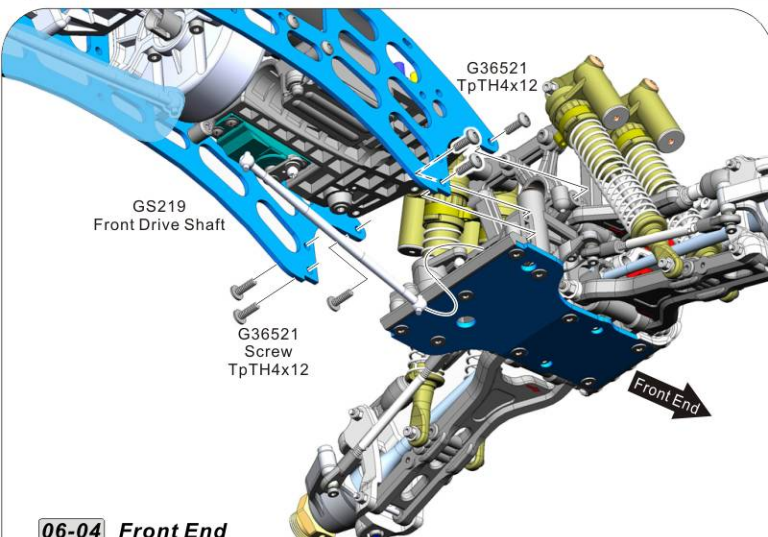
**06-04 Front End**

1. Line up the the front drive shaft into the joint cups of the tranny gear unit and front end.
2. Secure the front end to the middle frame with three screws on the each side plate as shown.

06-05 Front End

1. Next secure the front end to the radio tray with four screws for the upper of middle frame.
2. Finish securing the front end (steering posts) to the radio tray with two screws, the threaded lock is recommended.

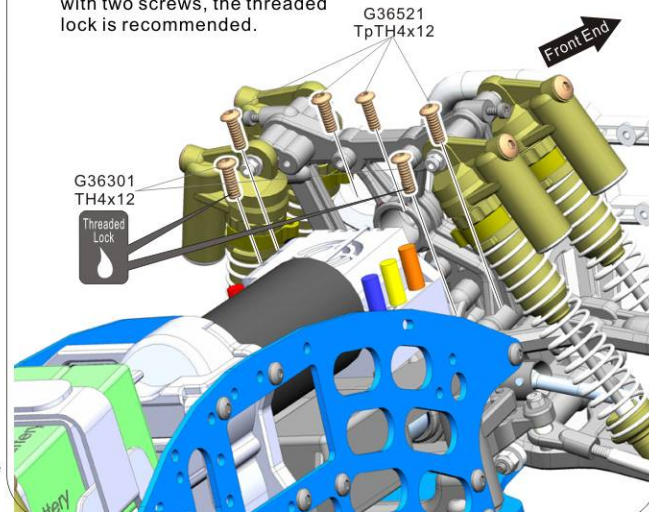

06-06 Rear End

1. Line up the rear drive shaft into the joint cups of the tranny gear unit and rear end.
2. Secure the rear end to the middle frame with three screws on the each side plate as shown.

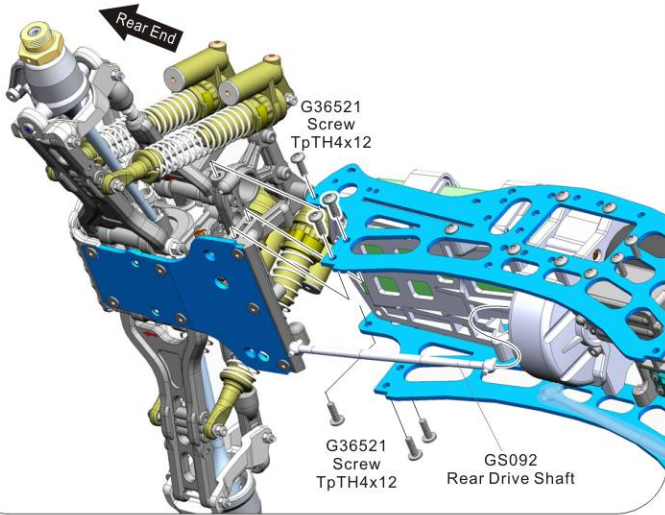

06-07 Rear End

1. Finish securing the rear end to the battery pan with four screws for the upper of middle frame.

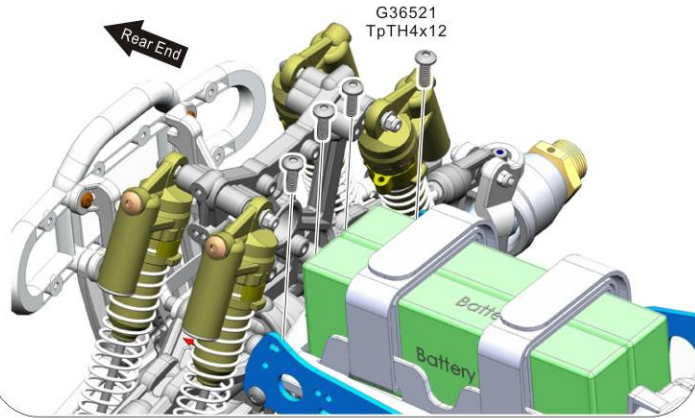

06-08 Steering Rod

1. Screw the ball cup and the ball end on equally until you get a distance of 20mm between them.
2. Gently snap the ball cup and ball end onto the ball studs. Minor adjusting maybe needed to get the servo horn and the bell crank parallel.

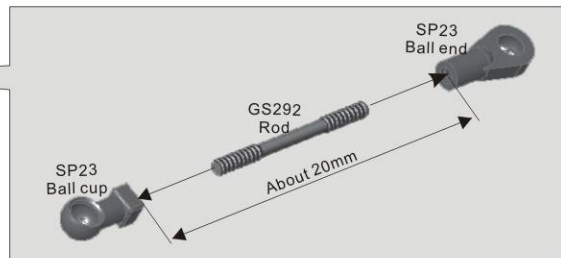
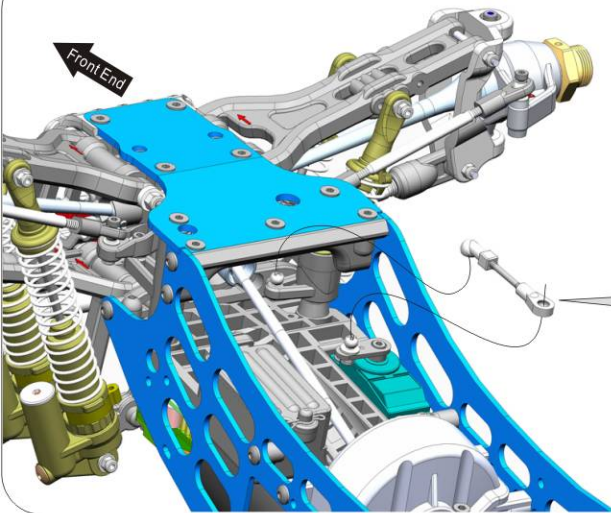

Rear End

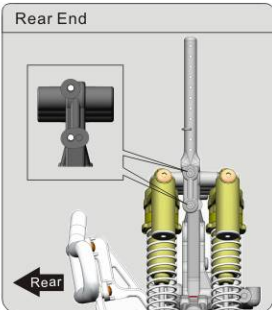

Front End

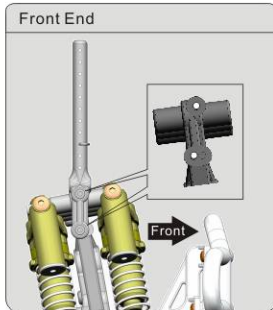

06-09 Body Mount

1. Mount four body mounts to the front and rear shock towers using eight screws. You will use two screws on each body mount.
2. Put one hook pin into the second hole from the bottom on each body mount.
3. After putting the shell body on secure with four hook pins.

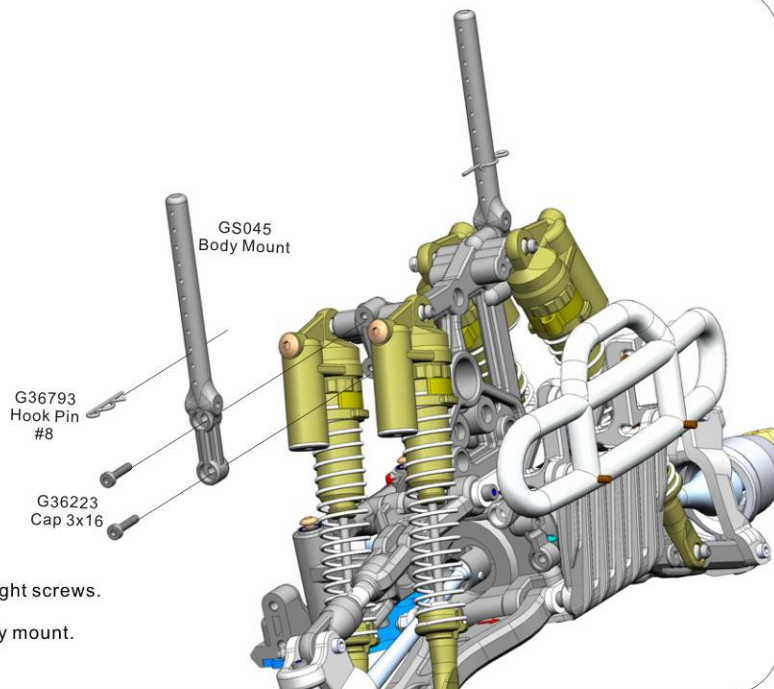

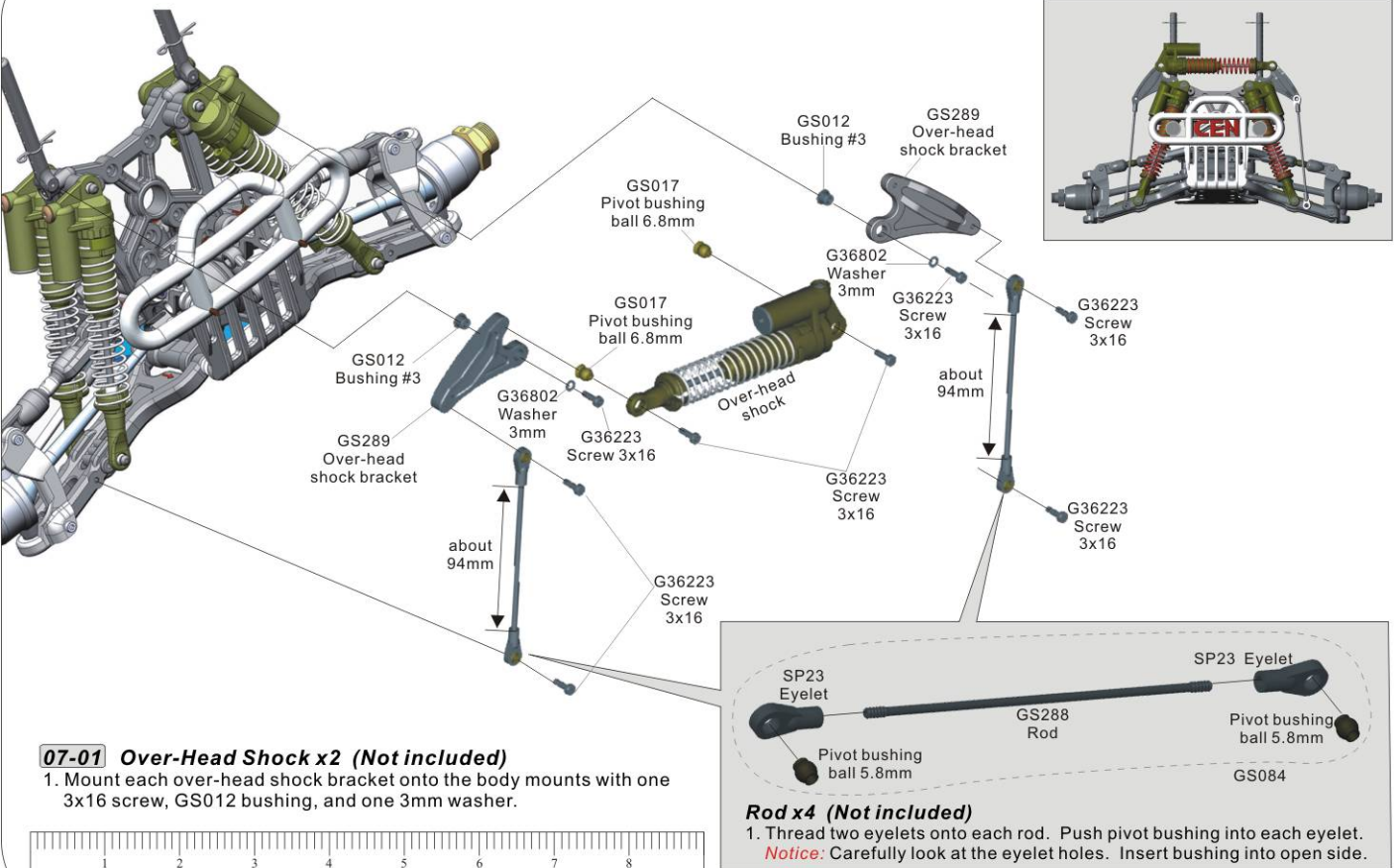

07-02 Tail Wing Unit (Not included)

1. Key the two wing posts into the wing stays as shown in the diagram. Next, install the wing mount to the wing stays using two screws. (Two Screws on each side) Now you are ready to mount the MX015 wing to the wing mount. Use the two screws to secure the wing to the mount as shown in the picture below. Don't forget to utilize the wing washers.

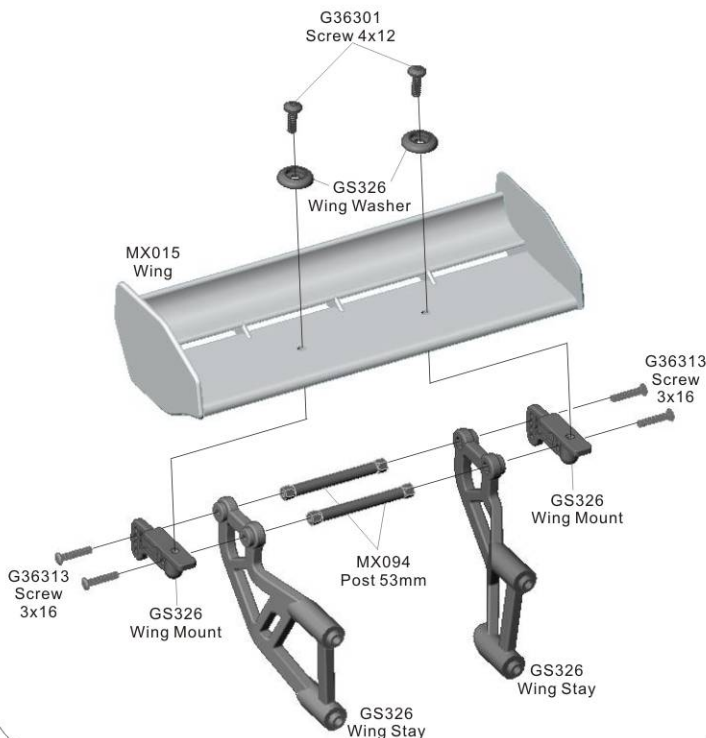

07-03 Tail Wing (Not included)

1. Now you are ready to install the tail wing unit to the Monster Truck. Do this by using four screws and screwing the tail wing unit to the rear shock tower of the Monster Truck as shown in the diagram below.

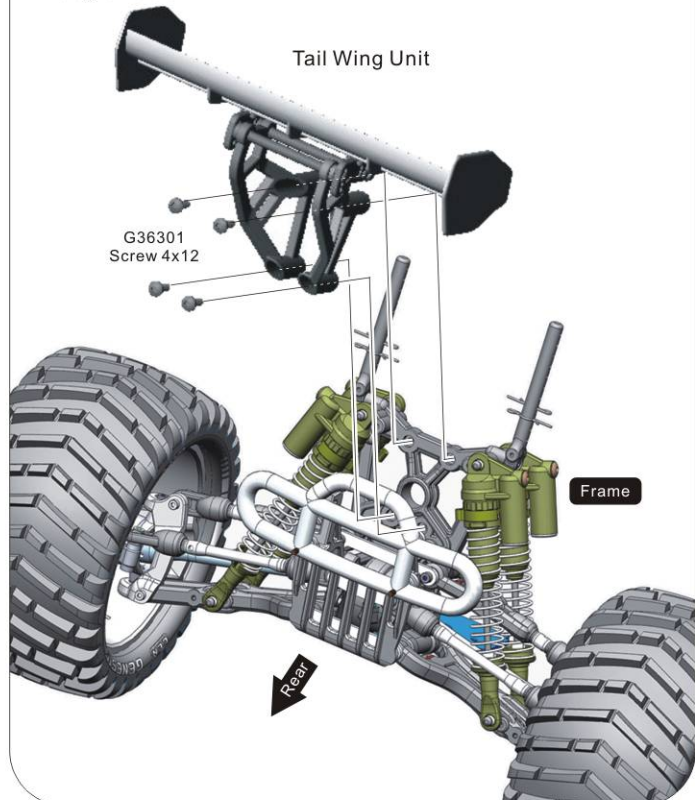

07-04 Wheels

1. First carefully seat the foam inside the tire.
2. Gently pull the tire with insert over the wheel. You want the mounting rib to sit in the ridge on the wheel.
Notice: The tires are directional. Refer to the picture of the later step for correct position.
3. After the tire is neatly seated on the wheel you need to glue the tires to the wheels.
4. Using CA glue, lift the tire up slightly from the wheel and apply a small bead around the entire wheel/tire.
5. Repeat for each side of each tire.

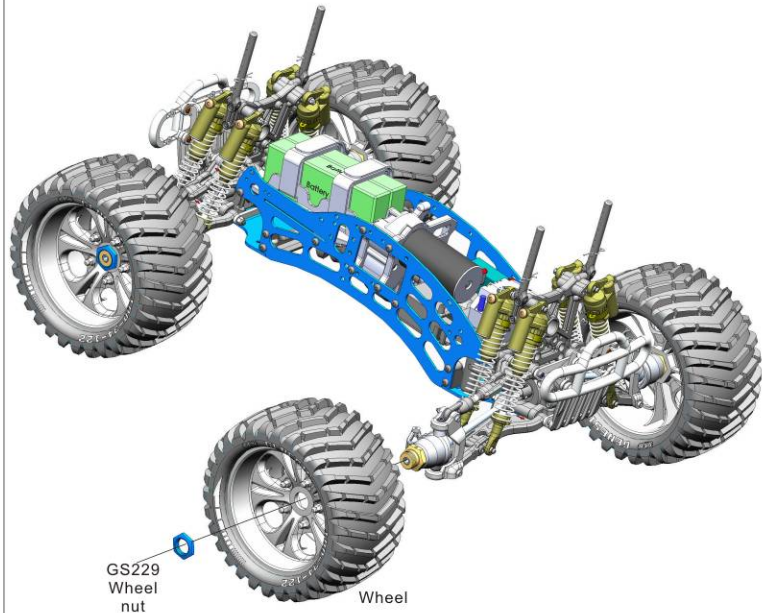

07-05 Wheels

1. After the glue on the tires has dried completely it is time to bolt them to the truck.
2. Using the wheel wrench, tighten down the wheel nuts.

07-06 Shell Body

1. The body comes pre-drilled for you.
2. Place shell body onto the post and secure with the body hook pins. Remember to extend the antenna wire of Receiver.

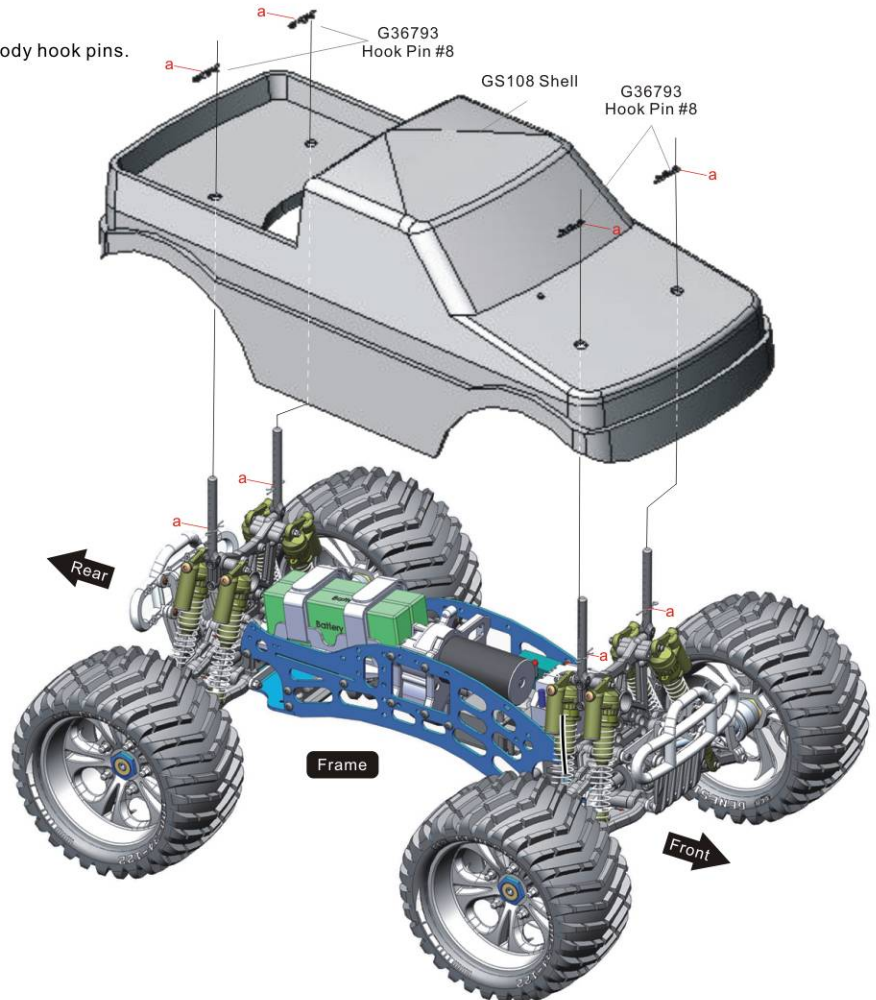

www.cenracing.de

Generalimporteur für Himoto Produkte

Krick Modelltechnik

Industriestrasse 1

75438 Knittlingen

Germany

E-Mail: info@krick-modell.de

Fax +49 (0)7043/31838